

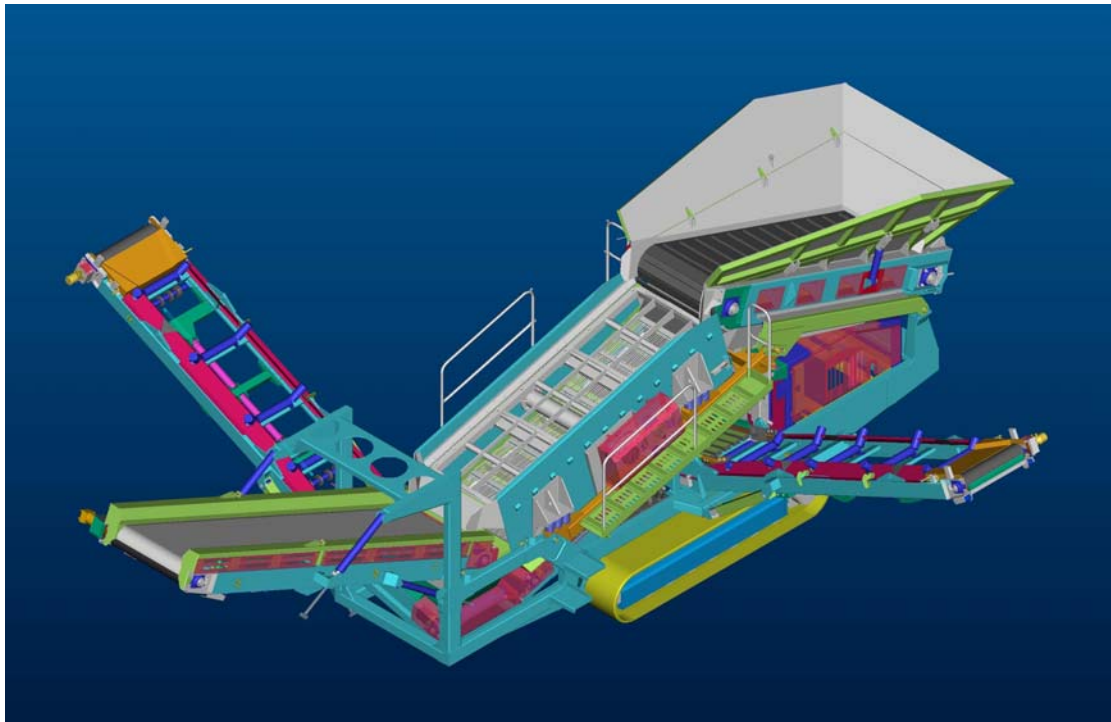

Powerscreen International. Dist. Ltd.
Coalisland Road, Dungannon,
Co.Tyrone, N.Ireland BT71 4DR
Tel: +44(0) 2887 740701
Fax: +44(0) 2887 746569
Email: mail@powerscreen.co.uk

INTRODUCING THE

WARRIOR 1400



All specifications subject to change without prior notice.

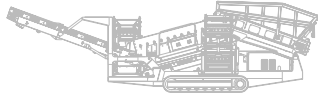

Technical Specification

Warrior 1400 01-04-2003

WARRIOR 1400

Page 2

FEATURES

- | | |
|--------------------------------|-------------------------------------|
| • Total weight (Belt Feeder) | 25,600 kg |
| • Width (transport) | 2.75 m (9') |
| • Length (transport / working) | 13.2 m (43'-3") |
| • Height (transport) | 3.2 m (10'6") |
| • Hopper capacity | 6.78 m ³ (8.87 cu. Yds.) |
| • Screenunit | 2-bearing 3.6m x 1.5m (12' x 5') |
| • Powerunit | Diesel Hydraulic. |

ADVANTAGES

- High capacity 500 TPH, (depending on mesh sizes and material type).
- Quick set up time typically under 15 minutes.
- Maximum mobility with heavy duty, low ground pressure crawler tracks.
- Removable heavy duty pendant remote control system.
- Optional radio control system available if required.
- High performance hydraulic system – David Brown pumps, Danfoss motors, Oil cooler, Commercial Hydraulics control valves.
- Access walkway for screenbox.
- Hydraulically folding hopper sides
- Heavy-duty 2-bearing screen box 10mm stroke standard, optional 12mm stroke if required.
- Hopper exit opening 1.2m wide enabling screening of large items i.e. tree stumps, logs, boulders, etc.

APPLICATIONS

- Sand and gravel
- Topsoil
- Coal
- Crushed stone
- Recycling
- Compost

UNLIMITED SOLUTIONS FOR LIMITED RESOURCES

All specifications subject to change without prior notice.



Technical Specification

Warrior 1400 01-04-2003

WARRIOR 1400

Page 3

Hopper:

Target area: 4.4m long x 2.7m wide.
Hopper capacity: 6.78 m³ (8.87 yrd³)
Feed in height: 2.88m (rear hopper door lowered)
Hardox side plates.
Lowering section to rear to reduce feed in height for smaller crushers.

Screenunit:

12' x 5' (3.6 x 1.5m) double deck 2-bearing.
15° to 18° screen angle adjustable.
Self adjusting motor stand.
12mm stroke @ 860 ±10 RPM
10mm stroke @ 920 ±10 RPM

Feed Conveyor:

1300mm (51") wide 4-ply plain belt. Direct feed conveyor fitted with twin direct drive system & hydraulic variable speed control.
Impact bars and 5 off 'extra heavy' duty impact rollers fitted beneath belt.
3.43m (11'-3") drum centres.
Optional 1300mm hardox apron feeder. (Currently undergoing extensive testing)

Collection Conveyor below screenbox:

1200mm (48") wide 3ply plain belt.
2.795m (9'-2") drum centres.

Fines Conveyor:

900mm (36") wide 3-ply plain belt.
Hydraulically folding.
3.45m (11'-4") stockpile height. (Measured to drum crown).
14° to 25° angle adjustable.
61 m³ (80 yrd³) Stockpile capacity.
Impact bars under feed boot.

Mid Product Conveyor:

900mm (36") wide 3-ply chevron belt.
Hydraulically folding.
3.3m (10'-9") stockpile height. (Measured to drum crown).
14° to 25° angle adjustable.
53.5 m³ (70 yrd³) Stockpile capacity.
Impact bars under feed boot.
Variable speed control.

UNLIMITED SOLUTIONS FOR LIMITED RESOURCES

All specifications subject to change without prior notice.

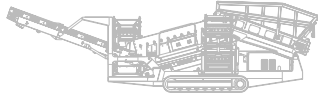

Technical Specification

Warrior 1400 01-04-2003

WARRIOR 1400

Page 4

Oversize Conveyor:

1200mm (48") wide 3-ply chevron belt.
Variable speed control.
Impact bar/ roller combination.
Conveyor slide up system for access to bottom deck meshes.
3.6 m (11'-10") stockpile height. (Measured to drum crown).
10° to 24° angle adjustable.

Powerunit & Hydraulics:

Diesel engine:	Caterpillar 3054 DIT, 82 kW (109 Hp), developing 74 kW (99Hp) at 2200 rpm.
Flywheel pump:	David Brown 5046/5033/5033
PTO pump:	David Brown 5023/5023 (23cc/rev each circuit)
Belt Feeder Motors:	Danfoss OMSS125 (125cc/rev)
Apron Feeder Motor:	Danfoss OMTS315 (315cc/rev)
Collection Conveyor Motor:	Danfoss OMH500 (500cc/rev)
Fines Conveyor Motor:	Danfoss OMH500 (500cc/rev)
Oversize Conveyor Motor:	Danfoss OMOV800 (800cc/rev)
Mid Conveyor Motor:	Danfoss OMH500 (500cc/rev)
Screen Motor:	David Brown MCC 2208 (59cc/rev)

Tank Capacities:

Hydraulic tank:	564 L (124 Gal)
Diesel tank:	336 L (74 Gal)

Crawler Track Data:

Tractive Effort	=	9,760 daN
Gradability Percentage	=	30.4 % (13.33deg)
Gearbox Ratio	=	1:122
Hydraulic Motor	=	Rexroth 63 cc/rev
Approximate Speed	=	1.02 Km/hr

Options:

Heavy duty Hardox Apron feeder instead of belt feeder.
Hardox or mild steel punch plate screens.
Finger screens on top or bottom decks.
'Z' meshes complete with ball deck and SCS™ (Self Cleaning Screen).
4" Bofor bar deck.

UNLIMITED SOLUTIONS FOR LIMITED RESOURCES

All specifications subject to change without prior notice.

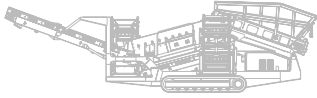

Technical Specification

Warrior 1400 01-04-2003

WARRIOR 1400

Page 5

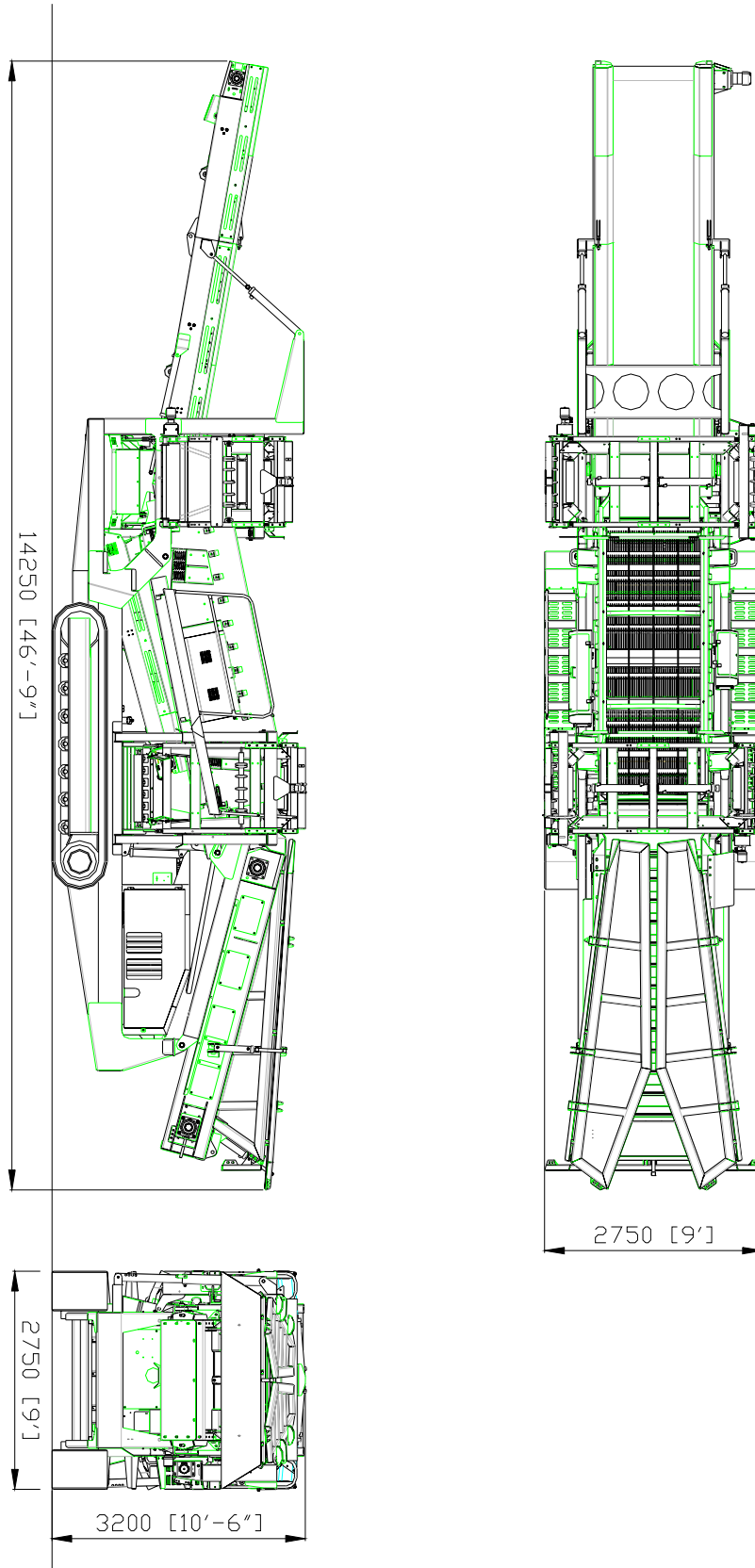

UNLIMITED SOLUTIONS FOR LIMITED RESOURCES

All specifications subject to change without prior notice.

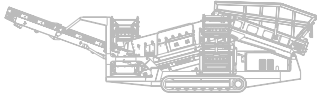

Technical Specification

Warrior 1400 01-04-2003

WARRIOR 1400

Page 6

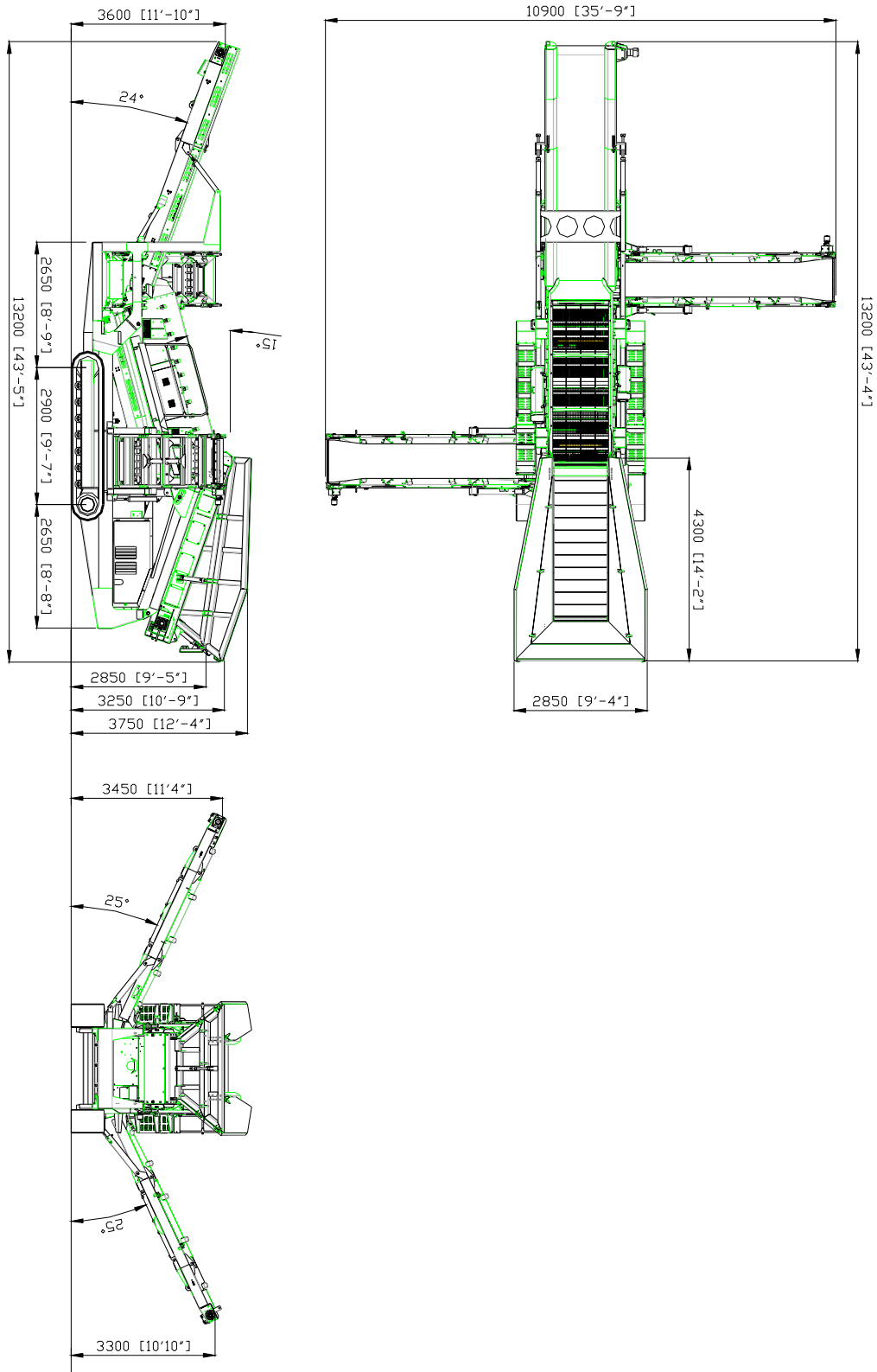

UNLIMITED SOLUTIONS FOR LIMITED RESOURCES

All specifications subject to change without prior notice.